

Timeless design, sculpted glow,  
softly lighting your way through  
every space.

Mizar news

issue #26

VITRUM SQUARE

# Vitrum Square

[*ˈvi:trum*]

VITRUM is simplicity with style: a sophisticated, elegant, and durable flush-mounted fixture, designed to blend into the environment and leave space for light to be the sole protagonist. Thanks to its minimalist design, the quality of its construction materials, and the various optical solutions available, it is the ideal choice for projects that require discretion and refinement, enhancing every context with harmony.

Now introducing Vitrum in its new square version, a refined evolution of its essential design.

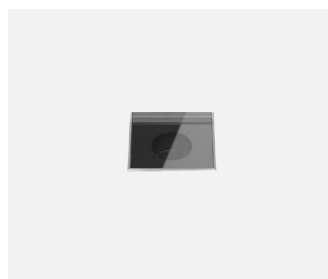

Vitrum Square 1.0

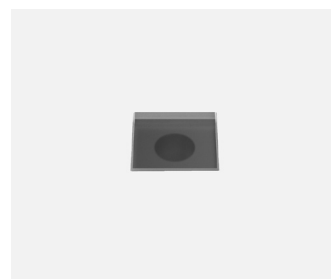

Vitrum Square 1.1



Vitrum Square 2.0

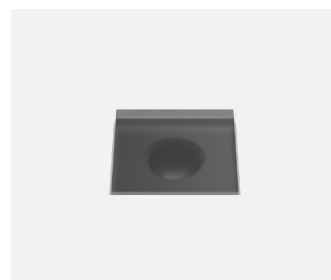

Vitrum Square 3.1



Vitrum Square 3.0

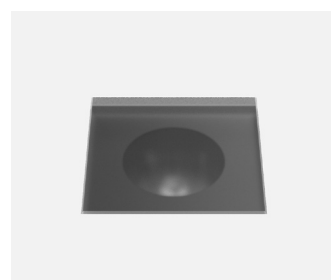

Vitrum Square 3.1





# Vitrum Square

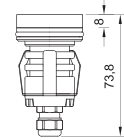
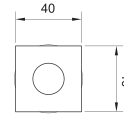

## 1.0

## 1.1

Source type	single chip power LED	single chip power LED
CCT	2700K	2700K
	3000K	3000K
	4000K	4000K
CRI	>90	>90
Step MacAdam	2	2
Lumen output	up to 99 lm	up to 64 lm
Beam angle	10°	Diffused
	36°	
	60°	
	10°x53°	
Optical optional	None	None
	Honeycomb	
	Louvre	
Lifetime	L80 B10 50.000h	L80 B10 50.000h
IP rating	IP66 / 68	IP66 / 68
IK rating	IK10	IK10
Finishing colour	Black silk-print	Black silk-print
	White silk-print	White silk-print
Body material	Anodized aluminum 20µ anticorodal	Anodized aluminum 20µ anticorodal
Diffuser material	6082	6082
Diffuser thickness	Extraclear tempered glass	Extraclear tempered glass
Class ISO 9223	8mm	8mm
Operating temperature	CX	CX
Static load	-20° C / +50° C	-20° C / +50° C
Walk-over	500 kg (5 kN)	500 kg (5 kN)
Drive-over	Yes	Yes
Power	No	No
Input power supply	2W	2W
Ballast	Costant voltage 24V	Costant voltage 24V
Insulation class	Remote	Remote
Dimmable	III Class	III Class
Cable type	Yes	Yes
Electrical connetion	H05RN-F 2x0,75mm <sup>2</sup>	H05RN-F 2x0,75mm <sup>2</sup>
Idroskud® protection	Parallel	Parallel
	Yes	Yes

### Photometry

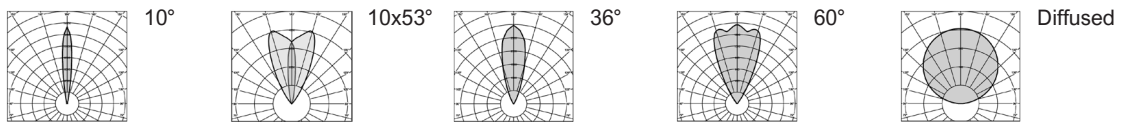

# Vitrum Square

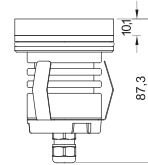
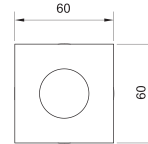

## 2.0

## 2.1

Source type	single chip power LED	single chip power LED
CCT	2700K	2700K
	3000K	3000K
	4000K	4000K
CRI	>90	>90
Step MacAdam	2	2
Lumen output	up to 152 lm	up to 101 lm
Beam angle	10°	Diffused
	25°	
	40°	
	10°x45°	
Optical optional	None	None
	Honeycomb	
	Louvre	
Lifetime	L80 B10 50.000h	L80 B10 50.000h
IP rating	IP66 / 68	IP66 / 68
IK rating	IK10	IK10
Finishing colour	Black silk-print	Black silk-print
	White silk-print	White silk-print
Body material	Anodized aluminum 20μ anticorodal	Anodized aluminum 20μ anticorodal
Diffuser material	6082	6082
Diffuser thickness	Extraclear tempered glass	Extraclear tempered glass
Class ISO 9223	10mm	10mm
Operating temperature	CX	CX
Static load	-20° C / +50° C	-20° C / +50° C
Walk-over	500 kg (5 kN)	500 kg (5 kN)
Drive-over	Yes	Yes
Power	No	No
Input power supply	3W	3W
Ballast	Costant voltage 24V	Costant voltage 24V
Insulation class	Remote	Remote
Dimmable	III Class	III Class
Cable type	Yes	Yes
Electrical connetion	H05RN-F 2x0,75mm <sup>2</sup>	H05RN-F 2x0,75mm <sup>2</sup>
Idroskud® protection	Parallel	Parallel
	Yes	Yes

### Photometry

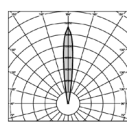

10°

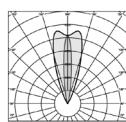

10x45°

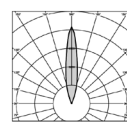

25°

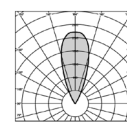

40°

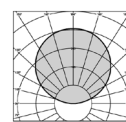

Diffused

# Vitrum Square

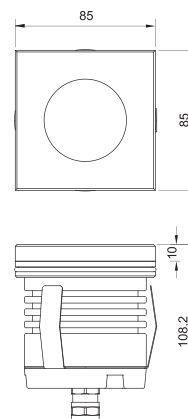

## 3.0

## 3.1

Source type	single chip power LED	single chip power LED
CCT	2700K	2700K
	3000K	3000K
	4000K	4000K
CRI	>90	>90
Step MacAdam	2	2
Lumen output	up to 370 lm	up to 258 lm
Beam angle	5°	Diffused
	20°	
	60°	
	15°x60°	
Optical optional	None	None
	Honeycomb	
	Louvre	
Lifetime	L80 B10 50.000h	L80 B10 50.000h
IP rating	IP66 / 68	IP66 / 68
IK rating	IK10	IK10
Finishing colour	Black silk-print	Black silk-print
	White silk-print	White silk-print
Body material	Anodized aluminum 20µ anticorodal	Anodized aluminum 20µ anticorodal
Diffuser material	6082	6082
Diffuser thickness	Extraclear tempered glass	Extraclear tempered glass
Class ISO 9223	10mm	10mm
Operating temperature	CX	CX
Static load	-20° C / +50° C	-20° C / +50° C
Walk-over	500 kg (5 kN)	500 kg (5 kN)
Drive-over	Yes	Yes
Power	No	No
Input power supply	7W	7W
Ballast	Costant voltage 24V	Costant voltage 24V
Insulation class	Remote	Remote
Dimmable	III Class	III Class
Cable type	Yes	Yes
Electrical connetion	H05RN-F 2x0,75mm <sup>2</sup>	H05RN-F 2x0,75mm <sup>2</sup>
Idroskud® protection	Parallel	Parallel
	Yes	Yes

### Photometry

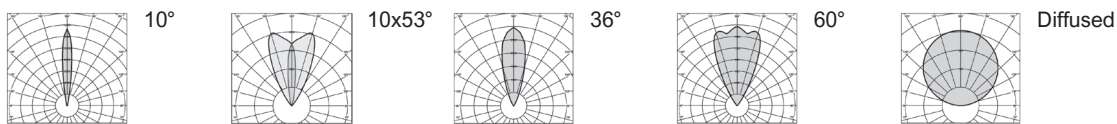





MIZAR  
a brand of ReeR spa

Via Carcano, 32  
10153 Turin - Italy

mizar.it  
info@mizar.it