



mizar

ACUS

Acus

[ˈa:kus]

ACUS, the family of robust, in-ground recessed luminaires with a minimalist design, ideal for driveways and pedestrian areas. Thanks to the elegant finishes in micro-blasted stainless steel and tempered glass, it guarantees maximum durability and resistance to stress. Available with narrow, medium, wide, symmetrical and tiltable optics, it offers great design flexibility. It also offers a surprising dynamic RGBW version, perfect for enhancing urban spaces with colorful and surprising atmospheres.



Acus



Acus 1.0



Acus 1.1



Acus 1.2



Acus 1.3 RGBW



Acus 2.0

mizar

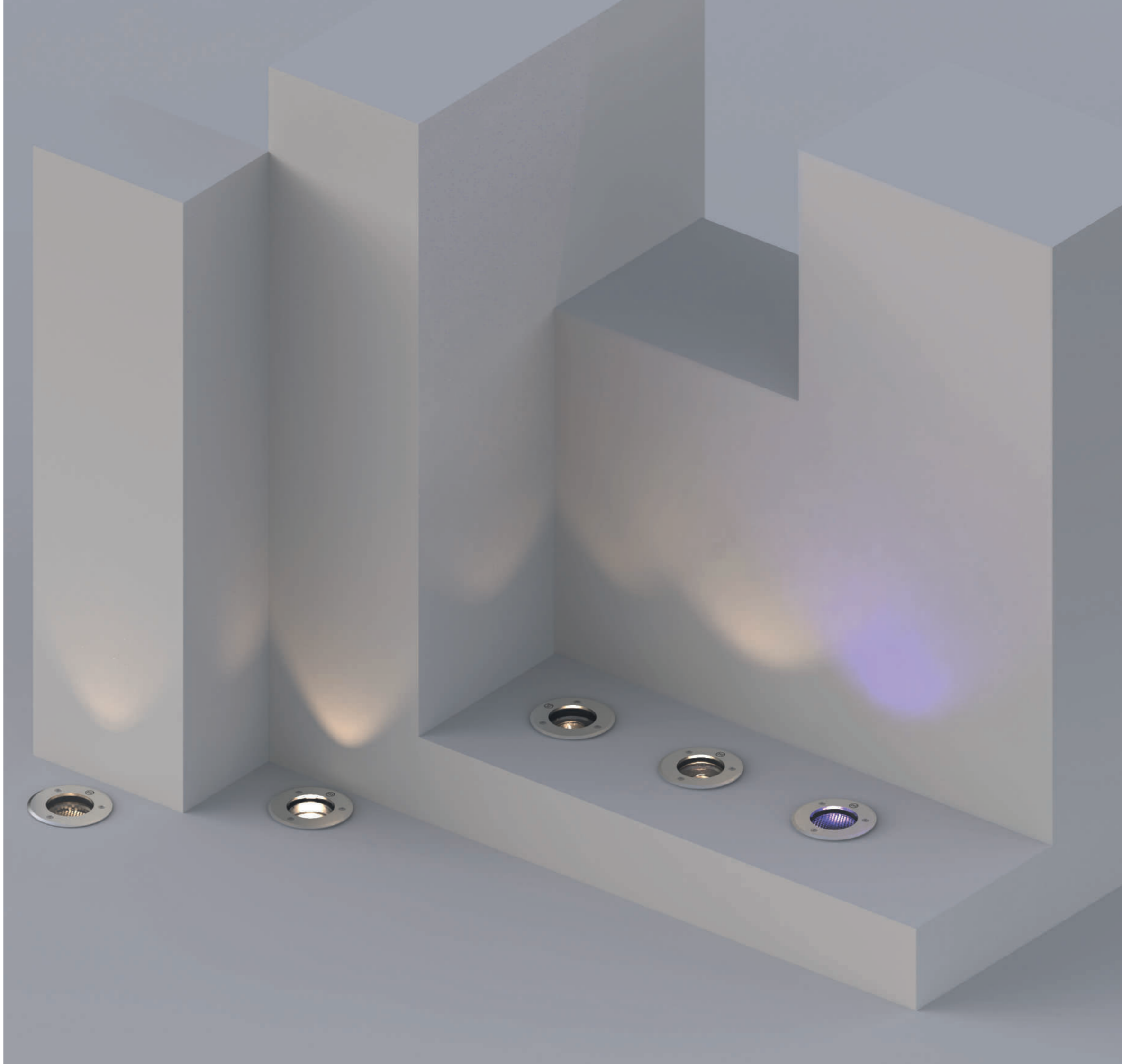

Acus / Product features



Construction quality as the first goal

At MIZAR we believe that one of the first features of a "Made in Italy" product is excellent build quality. The ACUS bezel is made of highly abrasion-resistant micro-bead-blasted 316L stainless steel, with a 12 mm thick extra-clear tempered glass diffuser. The body is made of 20µm black anodised 6082 anticorrosional aluminium. The product is supplied with a nickel-plated brass quick connector.

Corrosion resistance at the highest level

The care taken in the design and choice of materials allows the highest classes of the international ISO 9223 standard to be achieved. All ACUS are classified CX ("Extreme").



Designed to be drive-over

ACUS are products designed to be certified in driveway areas. Tested to withstand up to 20 kN static load (2000 kg), 5kN in acceleration and torsion (500 kg).



Highest degrees of protection

ACUS are fully protected against the ingress of any kind of dust (IP 6X) and protected against temporary immersion – up to 30 minutes – to a depth of 1 meter (IP X7). The products are also tested against high-pressure water jets (IP X6). 100 liters per minute, at a pressure of 100 kPa at a distance of 3 m.

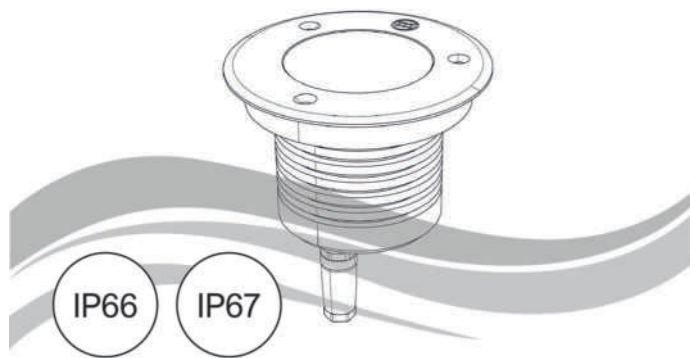

IdroSkud®

Innovative Mizar exclusive patent to protect electronic components from voltage spikes, polarity reversal, moisture or water infiltrations through the power cable.

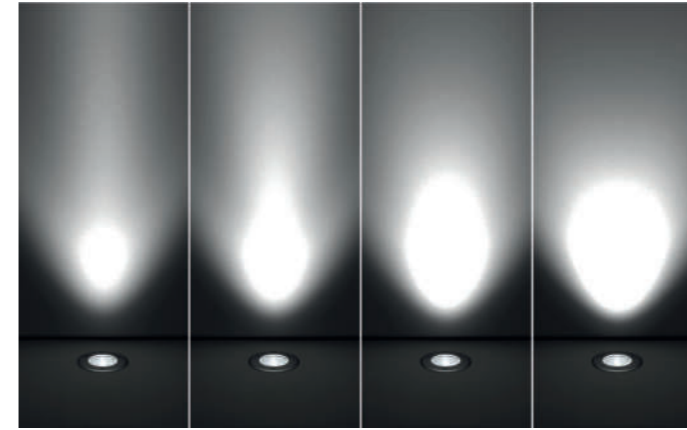

Wide range of optics

All ACUS can be equipped with narrow, medium or wide optics. Offering maximum flexibility in lighting design. The range also offers a choice of technopolymer TIR lenses (ACUS 1.0, 1.2, 1.3 and 2.0), fresnel or aluminised reflectors (ACUS 1.1).



Maximum flexibility in aiming

ACUS 2.0 versions are equipped with tilting optics. By acting on the lower part of the product body, without opening it, aiming can be oriented. This allows immediate adjustment of the optics, on any axis of the product.



Wide choice of color temperatures and RGBW dynamic scenarios

The ACUS series is offered with a wide choice of color temperatures: 2700K, 3000K and 4000K. As the ACUS is designed to illuminate façades, as well as in different colour temperatures, it is also offered in a colour-changing version, to create lively and dynamic scenarios. The ACUS 1.3 is equipped with RGBW sources, controlled by PWM (or DMX on request).



Acus 1.0

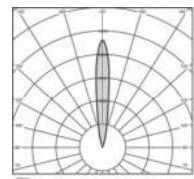
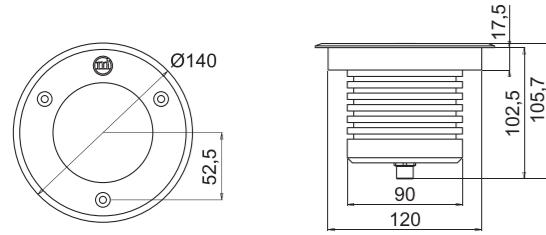

14°

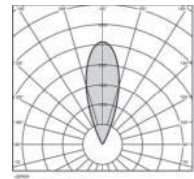

35°

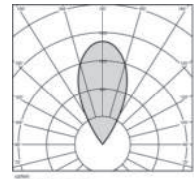

55°

Source type	LED COB
CCT	2700K 3000K 4000K
CRI	>90
Step MacAdam	3
Lumen output	up to 1612 lm
Beam angle	14° 35° 55°
Optical optional	None Honeycomb Louvre
LED Lifetime	L80 B10 50.000h
IP rating	IP66 / 67
IK rating	IK10
Bezel material	Shot peened stainless steel 316L
Body material	Anodized aluminium 20µm anticorodal 6082
Diffuser material	Extra-clear tempered glass
Diffuser thickness	12mm
ISO 9223 class	CX
Operating temperature	-20°C / +50° C
Maximum static load	20kN (2000kg)
Walk-over	Yes
Drive-over	Yes
Power	20W
Input power type	Constant current 500mA
Power supply	Remote
Insulation class	Class III
Dimmable	Yes
Connector type	M12 five poles IP67
Electrical connection	Series
Idroskud® protection	Yes

Acus 1.1

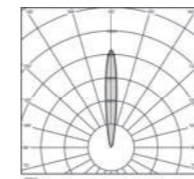
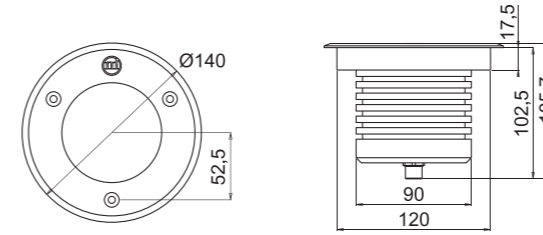

12°

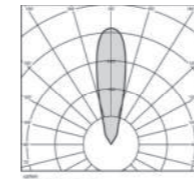

25°

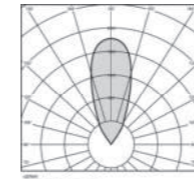

40°

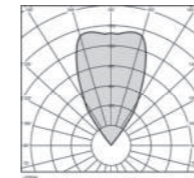

60°

Source type	LED COB
CCT	2700K 3000K 4000K
CRI	>90
Step MacAdam	3
Lumen output	up to 2183 lm
Beam angle	12° 25° 40° 60°
Optical optional	None Honeycomb Louvre
LED Lifetime	L80 B10 50.000h
IP rating	IP66 / 67
IK rating	IK10
Bezel material	Shot peened stainless steel 316L
Body material	Anodized aluminium 20µm anticorodal 6082
Diffuser material	Extra-clear tempered glass
Diffuser thickness	12mm
ISO 9223 class	CX
Operating temperature	-20°C / +50° C
Maximum static load	20kN (2000kg)
Walk-over	Yes
Drive-over	Yes
Power	25W
Input power type	Constant current 700mA
Power supply	Remote
Insulation class	Class III
Dimmable	Yes
Connector type	M12 five poles IP67
Electrical connection	Series
Idroskud® protection	Yes

Acus 1.2

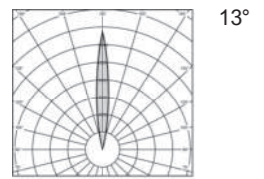
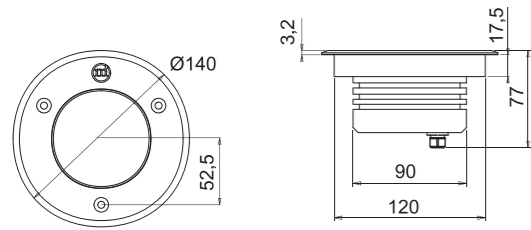

13°

Source type	LED COB
CCT	2700K 3000K 4000K
CRI	>90
Step MacAdam	3
Lumen output	up to 1098 lm
Beam angle	13°

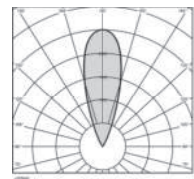

36°

Beam angle	36°
Beam angle	60°
Beam angle	A20°
Optical optional	None Honeycomb
LED Lifetime	L80 B10 50.000h
IP rating	IP66 / 67
IK rating	IK10

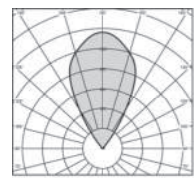

60°

Bezel material	Shot peened stainless steel 316L
Body material	Anodized aluminium 20µm anticorodal 6082
Diffuser material	Extra-clear tempered glass
Diffuser thickness	12mm
ISO 9223 class	CX
Operating temperature	-20°C / +50° C
Maximum static load	20kN (2000kg)
Walk-over	Yes
Drive-over	Yes
Power	13W

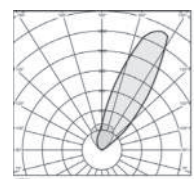

A20°

Input power type	Constant current 700mA
Power supply	Remote
Insulation class	Class III
Dimmable	Yes
Connector type	M12 five poles IP67
Electrical connection	Series
Idroskud® protection	Yes

Acus 1.3 RGBW

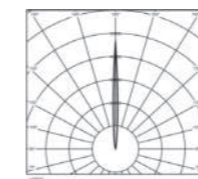
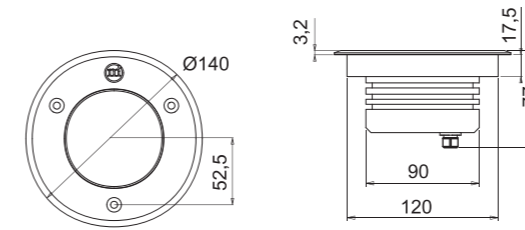

5°

Source type	LED multi-chip
CCT	RGBW (4000K)
CRI	>80
Step MacAdam	3
Lumen output	up to 546 lm
Beam angle	5°
Beam angle	26°
Beam angle	40°

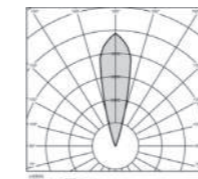

26°

Optical optional	None Honeycomb
LED Lifetime	L80 B10 50.000h
IP rating	IP66 / 67
IK rating	IK10
Bezel material	Shot peened stainless steel 316L
Body material	Anodized aluminium 20µm anticorodal 6082
Diffuser material	Extra-clear tempered glass
Diffuser thickness	12mm

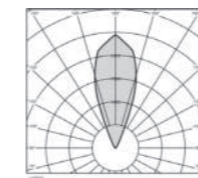

40°

ISO 9223 class	CX
Operating temperature	-20°C / +50° C
Maximum static load	20kN (2000kg)
Walk-over	Yes
Drive-over	Yes
Power	13W
Input power type	Constant voltage 24V
Power supply	Remote
Insulation class	Class III
Dimmable	Yes (PWM)
Connector type	M12 eight poles IP67
Electrical connection	Parallel
Idroskud® protection	Yes

Acus 2.0

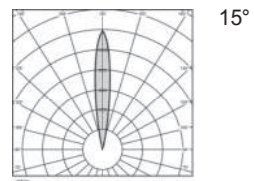
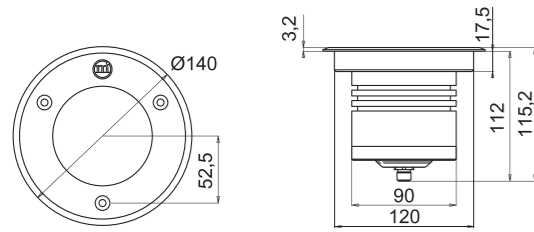

15°

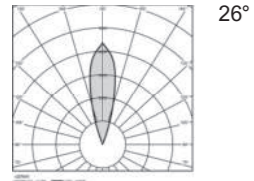

26°

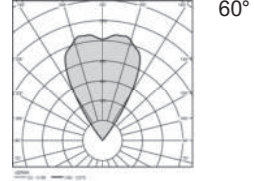

60°

Source type	LED COB
CCT	2700K 3000K 4000K
CRI	>90
Step MacAdam	3
Lumen output	up to 1195 lm
Beam angle	15° 26° 60°
Optical optional	None Honeycomb
LED Lifetime	L80 B10 50.000h
IP rating	IP66 / 67
IK rating	IK10
Bezel material	Shot peened stainless steel 316L
Body material	Anodized aluminium 20µm anticorodal 6082
Diffuser material	Extra-clear tempered glass
Diffuser thickness	12mm
ISO 9223 class	CX
Operating temperature	-20°C / +50° C
Maximum static load	20kN (2000kg)
Walk-over	Yes
Drive-over	Yes
Power	13W
Input power type	Constant current 700mA
Power supply	Remote
Insulation class	Class III
Dimmable	Yes
Connector type	M12 five poles IP67
Electrical connection	Series
Idroskud® protection	Yes



Accessories

Type	Model	Code	Description
Recessed box	ACUS 1.0 / 1.1 / 1.2 / 1.3 / 2.0	ACUZZZ000	Drive-over recessed box

Code configurator

Model	CCT	CRI	Beam angle	Optical options	Finishing	Cable length	Version
ACU00 ACUS 1.0	C 2700K	C CRI > 90	S 14°	0 None	00 Steel	Z n.c.	00 series 500mA
	D 3000K		M 35°	2 Honeycomb			
	F 4000K		L 55°	3 Louvre			
ACU01 ACUS 1.1	C 2700K	C CRI > 90	S 12°	0 None	00 Steel	Z n.c.	00 series 700mA
	D 3000K		M 25°	2 Honeycomb			
	F 4000K		L 40°	3 Louvre			
			W 60°				
ACU02 ACUS 2.0	C 2700K	C CRI > 90	S 15°	0 None	00 Steel	Z n.c.	00 series 700mA
	D 3000K		M 26°	2 Honeycomb			
	F 4000K		L 60°				
ACU03 ACUS 1.2	C 2700K	C CRI > 90	A A20°	0 None	00 Steel	Z n.c.	00 series 700mA
	D 3000K		2 Honeycomb				
	F 4000K						
ACU04 ACUS 1.2	C 2700K	C CRI > 90	S 13°	0 None	00 Steel	Z n.c.	00 series 700mA
	D 3000K		M 36°	2 Honeycomb			
	F 4000K		L 60°				
ACU05 ACUS 1.3	P RGBW	C CRI > 80	S 5°	0 None	00 Steel	Z n.c.	00 parallel 24V
			M 26°	2 Honeycomb			
			L 40°				

Configuration example

ACU00	C	C	S	0	00	Z	00
ACU00CCS000Z00 - ACUS 1.0 20W 14° 2700K 500mA							

n.c. = not pre-wired

Power supplies

Consult the power supply table on the Mizar website in the Download section



Type	Model	Code	Description
Power supply	ACUS 1.0 / 1.1 / 1.2 / 2.0	MID0025	Power supply DC 10-54V 1,5/38W 150-1050mA IP20 DALI/NFC
Power supply	ACUS 1.0 / 1.1 / 1.2 / 2.0	MID0027	Power supply DC 2-49V 1/30W 250-700mA IP68 DALI
Power supply	ACUS 1.1 / 1.2 / 2.0	MID0022	Power supply DC 5-44V 700mA 30W IP20 ON/OFF
Power supply	ACUS 1.1 / 1.2 / 2.0	MID0026	Power supply DC 10-50V 15/70W 700mA IP68 ON/OFF
Power supply	ACUS 1.3	MID0020	Power supply DC 24V 36W 1,5A IP67 ON/OFF
Power supply	ACUS 1.3	MID0021	Power supply DC 24V 24W 1A IP67 DALI
Power supply	ACUS 1.3	MID0028	Power supply DC 24V 70W 2,9A IP67 ON/OFF
Power supply	ACUS 1.3	MID0029	Power supply DC 24V 150W 6,25A IP67 ON/OFF
Power supply	ACUS 1.3	MID0030	Power supply DC 24V 120W 5A IP67 DALI2/PWM
Power supply	ACUS 1.3	MID0031	Power supply DC 24V 200W 5A IP67 DALI2/PWM
Control unit	ACUS 1.3	MID0023	Control unit WT5 5 channels RGBW PWM/WiFi
Remote	ACUS 1.3	MID1000	Remote RT5 RGB+CCT 1 zone RF 2.4GHZ
Touch panel	ACUS 1.3	MID1001	Touch panel da parete TW5-4 RGB+CCT 4 zones





MIZAR
a brand of ReeR spa

Via Carcano, 32
10153 Turin - Italy

mizar.it
info@mizar.it