



mizar

OCEANO

# Oceano

[o'tʃe:ano]



OCEANO is the versatile solution designed to integrate elegantly into any architectural context. Available in different shapes and sizes, it offers versatile solutions thanks to its floor, wall, or ceiling installation options. Resistant materials and refined finishes guarantee extreme durability and unmistakable style, while customizable optics and color temperatures allow maximum design freedom. Top of the range for sophisticated, reliable lighting that is always aligned with the needs of the project.



# Oceano

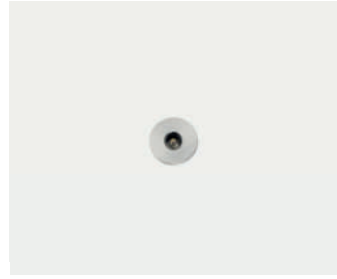

Oceano 1.0

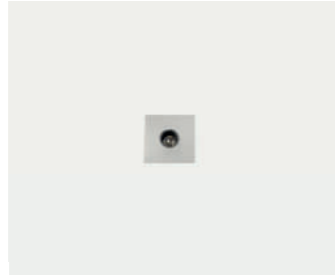

Oceano 1.1

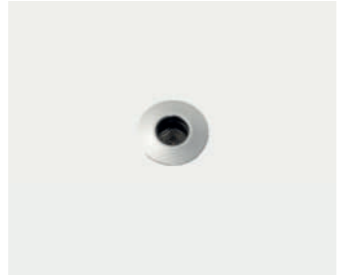

Oceano 2.0



Oceano 2.1

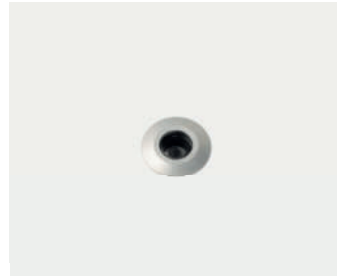

Oceano 3.0

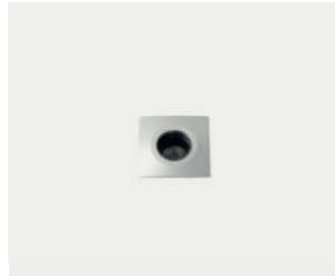

Oceano 3.1



Oceano 4.0



Oceano 4.1



Oceano 3.2



Oceano 3.3



Oceano 4.2



Oceano 4.3

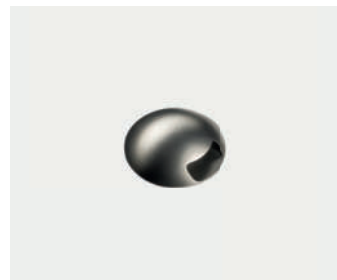

Oceano 9.1

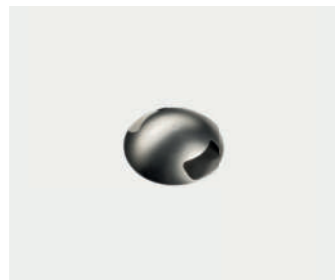

Oceano 9.2

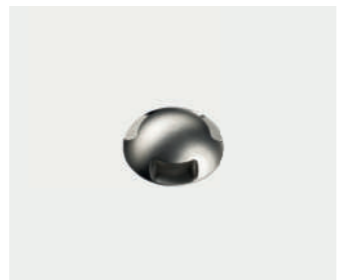

Oceano 9.3

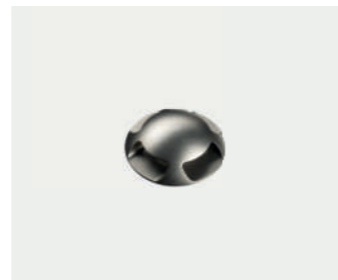

Oceano 9.4

mizar

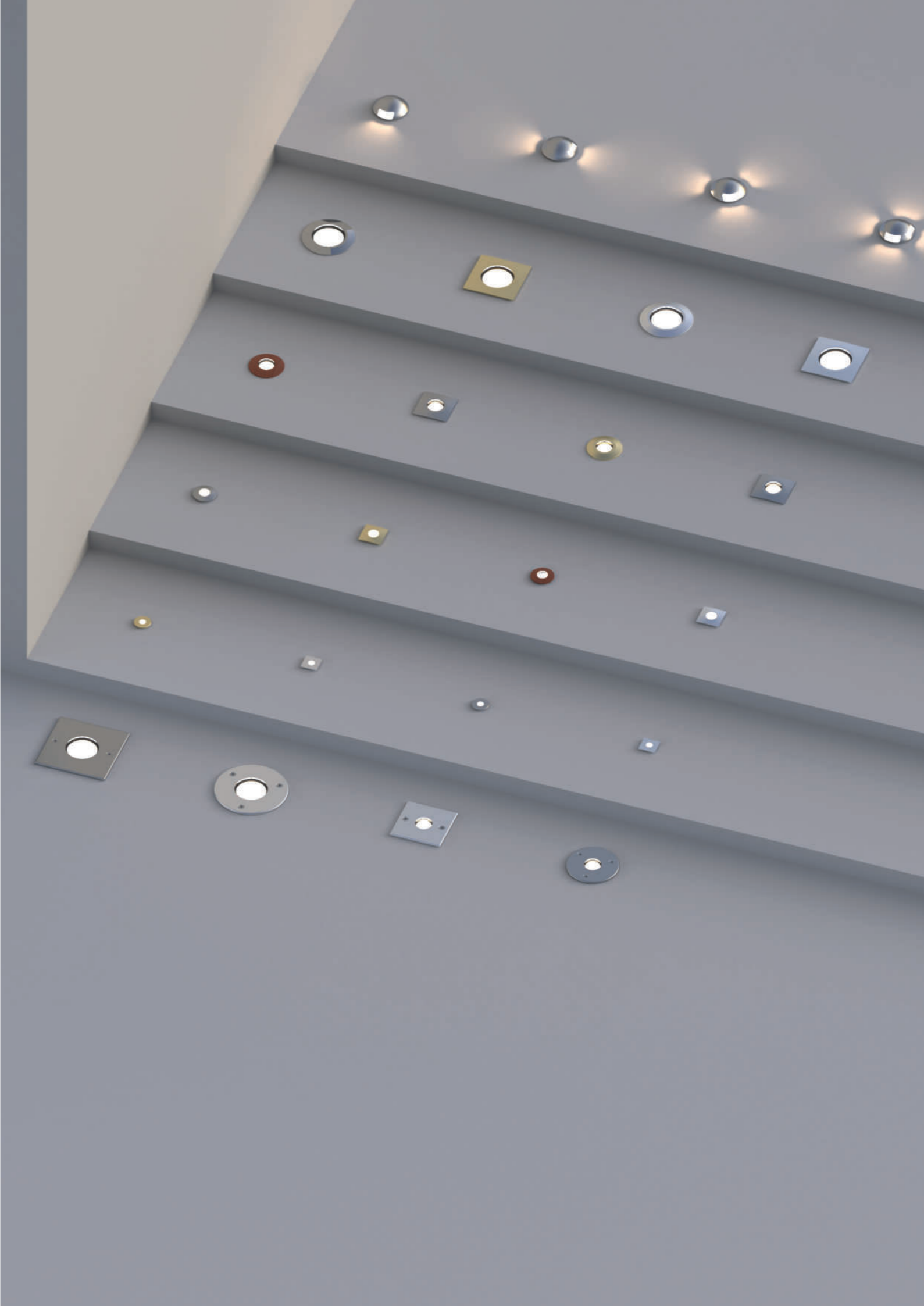

# Oceano / Product features



## Construction quality as the first goal

At Mizar we think that one of the first features of a "Made in Italy" product is excellent build quality. OCEANOs are turned from solid, 20µm neutral anodized 6082 anticorrosional aluminum or 316L stainless steel. The bezels are manufactured in the same materials. Versions with marine brass bezels are available. The diffuser is made of extra-clear tempered glass. TIR optics are made of technopolymer.

## Corrosion resistance at the highest level

The care taken in the design and choice of materials makes it possible to achieve the highest classes of the international ISO 9223 standard. All OCEANOs made of anodized aluminum are rated C5 ("Very High"). All OCEANOs made of stainless steel or brass are rated CX ("Extreme").

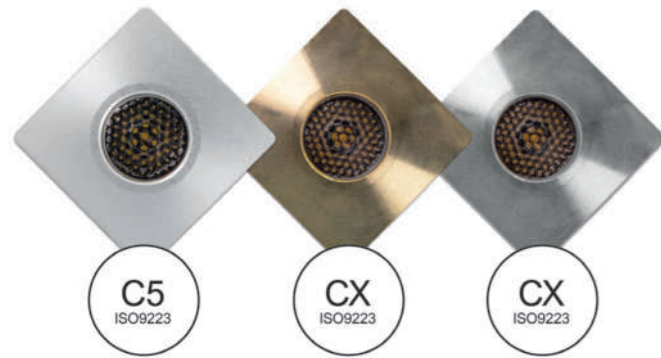

## Wood effect

Made from an innovative polymer resin, OCEANO perfectly mimics the color and grain of wood, making it an ideal choice for installations on wood surfaces. Whether enhancing outdoor landscapes, or even the teak-clad decks of luxury yachts, OCEANO is designed to disappear into its surroundings while offering extraordinary corrosion resistance.

## Designed to be drive-over

Models OCEANO 3.2, 3.3, 4.2 and 4.3 are designed to be certified in driveway areas. Tested to withstand up to 20kN static load (2000kg), 5kN in acceleration and torsion (500 kg).

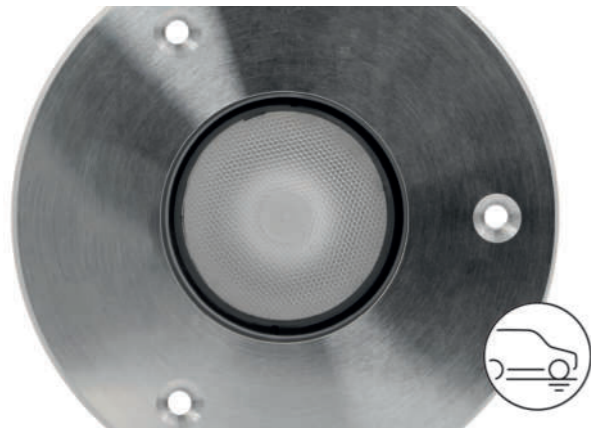

## IdroSkud®

Innovative Mizar exclusive patent to protect electronic components from voltage spikes, polarity reversal, moisture or water infiltrations through the power cable.

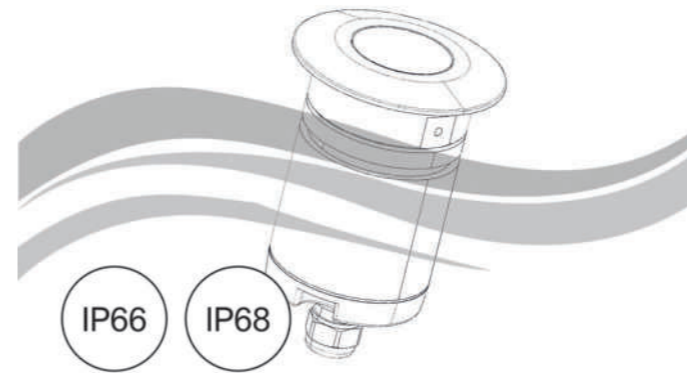

## Highest degrees of protection

OCEANOs are fully protected against entry of any kind of dust (IP 6X) and protected against permanent immersion to a depth of 3 meters (IP X8). Oceano 3 and Oceano 4 sizes are protected to a depth up to 10 meters. The products are also tested against high-pressure water jets (IP X6). 100 liters per minute, with a pressure of 100 kPa at a distance of 3 m.

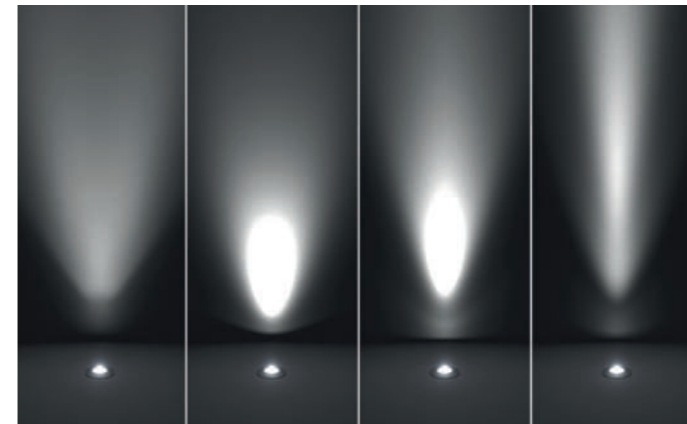

## Wide range of optics

All OCEANOs can be equipped with narrow, medium, wide or elliptical optics. Maximum design flexibility at the lighting level.



## Grazing lighting effects

Oceano 9s are models equipped with optical silicone lens with grazing distribution, to illuminate paths and walkways or to create scenic effects on walls.

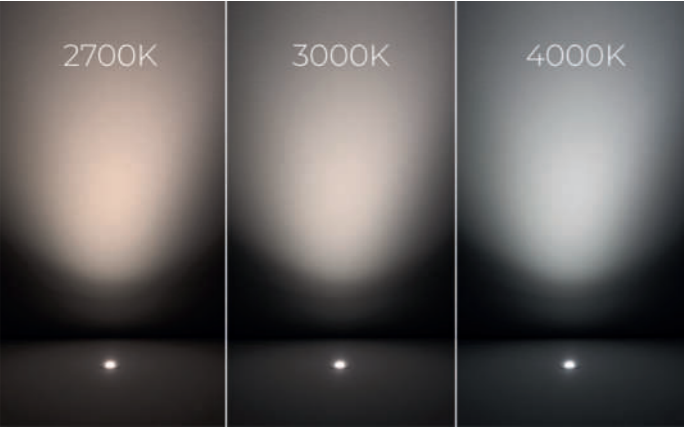

**Wide choice of color temperatures**

The OCEANO series is offered with a wide choice of color temperatures: 2700K, 3000K and 4000K. In addition – upon request – versions with extremely warm color temperature (2200 K) are available.

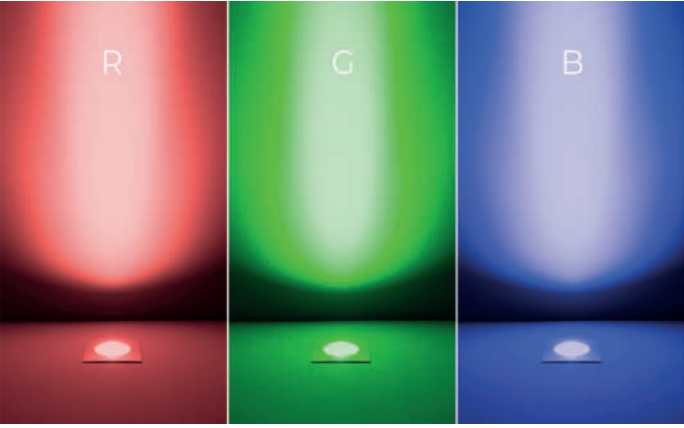

**RGBW dynamic scenarios**

The OCEANO series, in addition to different color temperatures, in the OCEANO 4.0 and 4.1 models is available in versions equipped with RGBW sources, controlled in PWM.



**Faithful reproduction of colors**

OCEANO series products are equipped with a range of the highest quality LED light sources. Color rendering index (CRI) > 90. They also offer very high color consistency, with a Step MacAdam value of 2.

## Oceano 1.0

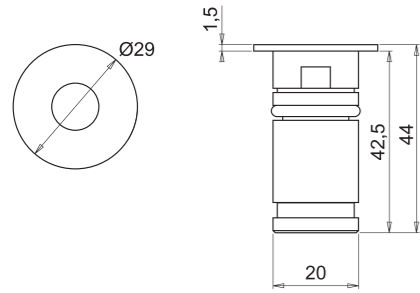

## Oceano 1.1

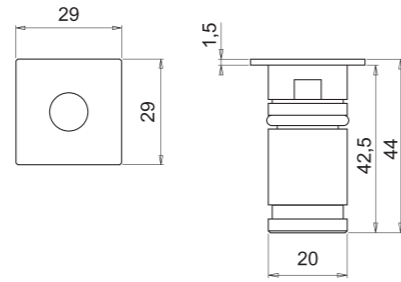

## Oceano 2.0

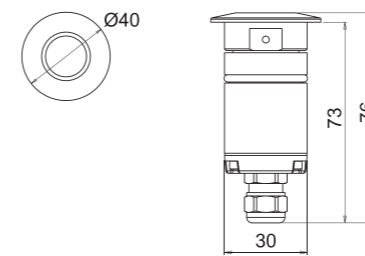

## Oceano 2.1

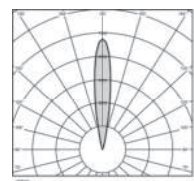
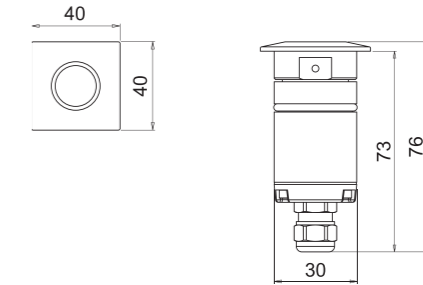

15°

Source type	single power-LED
CCT	2700K 3000K 4000K
CRI	>90
Step MacAdam	2
Lumen output	up to 71 lm
Beam angle	15° 25° 40° 20°x43°
Optical optional	None
LED Lifetime	L80 B10 50.000h
IP rating	IP66 / 68
IK rating	IK09
Bezel material	Anodized aluminium 20µm anticorodal 6082 Stainless steel 316L Brass

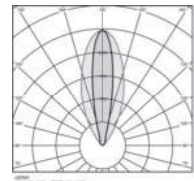

20°x43°

Body material	Anodized aluminium 20µm anticorodal 6082 Stainless steel 316L
Diffuser material	Extra-clear tempered glass
Diffuser thickness	4mm
ISO 9223 class	C5 CX

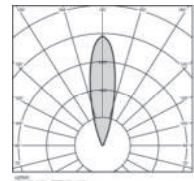

25°

Operating temperature	-20°C / +50° C
Maximum static load	5kN (500kg)
Walk-over	Yes
Drive-over	No
Power	1W
Input power type	Constant voltage 24V
Power supply	Remote
Insulation class	Class III
Dimmable	Yes
Cable type	FR5FOEM7-AD8 2x0,5 mm²
Electrical connection	Parallel
Idroskud® protection	Yes

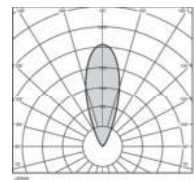

40°

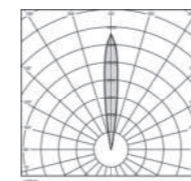

10°

Source type	single power-LED
CCT	2700K 3000K 4000K
CRI	>90
Step MacAdam	2
Lumen output	up to 99 lm
Beam angle	10° 36° 60° 10°x53°
Optical optional	None Honeycomb
LED Lifetime	L80 B10 50.000h
IP rating	IP66 / 68
IK rating	IK07
Bezel material	Anodized aluminium 20µm anticorodal 6082 Stainless steel 316L Brass Technopolymer (wood effect)

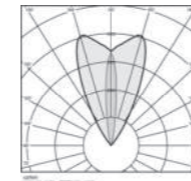

10°x53°

Body material	Anodized aluminium 20µm anticorodal 6082 Stainless steel 316L
Diffuser material	Extra-clear tempered glass
Diffuser thickness	6mm
ISO 9223 class	C5 CX

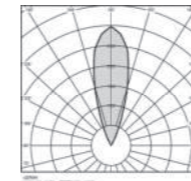

36°

Operating temperature	-20°C / +50° C
Maximum static load	5kN (500kg)
Walk-over	Yes
Drive-over	No
Power	2W
Input power type	Constant voltage 24V
Power supply	Remote
Insulation class	Class III
Dimmable	Yes
Cable type	H05RN-F 2x0,75 mm²
Electrical connection	Parallel
Idroskud® protection	Yes

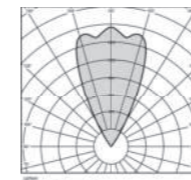

60°

Operating temperature	-20°C / +50° C
Maximum static load	5kN (500kg)
Walk-over	Yes
Drive-over	No
Power	2W
Input power type	Constant voltage 24V
Power supply	Remote
Insulation class	Class III
Dimmable	Yes
Cable type	H05RN-F 2x0,75 mm²
Electrical connection	Parallel
Idroskud® protection	Yes

## Oceano 3.0

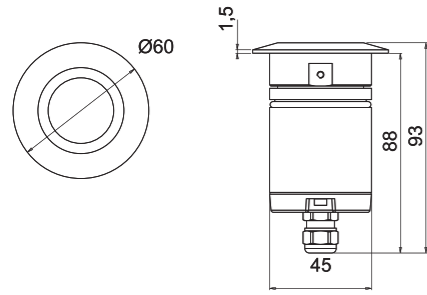

## Oceano 3.1

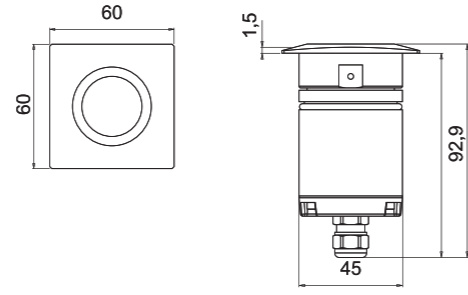

## Oceano 3.2

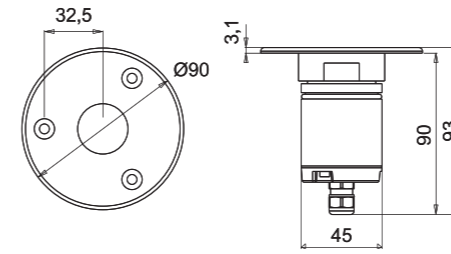

## Oceano 3.3

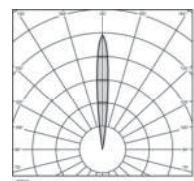
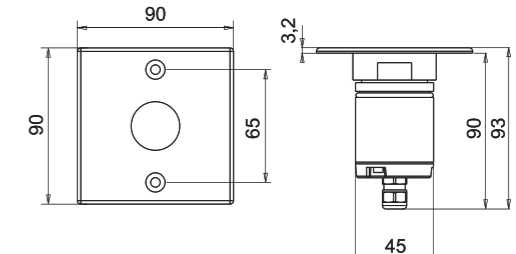

10°

Source type	single power-LED
CCT	2700K 3000K 4000K
CRI	>90
Step MacAdam	2
Lumen output	up to 152 lm
Beam angle	10° 25° 40° 10°x45°
Optical optional	None Honeycomb Louvre
LED Lifetime	L80 B10 50.000h
IP rating	IP66 / 68 10m
IK rating	IK10
Bezel material	Anodized aluminium 20µm anticorodal 6082 Stainless steel 316L Brass Technopolymer (wood effect)
Body material	Anodized aluminium 20µm anticorodal 6082 Stainless steel 316L
Diffuser material	Extra-clear tempered glass
Diffuser thickness	8mm
ISO 9223 class	C5 CX
Operating temperature	-20°C / +50° C
Maximum static load	5kN (500kg)
Walk-over	Yes
Drive-over	No
Power	3W
Input power type	Constant voltage 24V
Power supply	Remote
Insulation class	Class III
Dimmable	Yes
Cable type	H05RN-F 2x0,75 mm <sup>2</sup>
Electrical connection	Parallel
Idroskud® protection	Yes

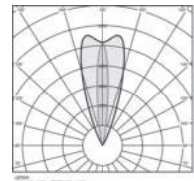

10°x45°

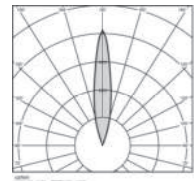

25°

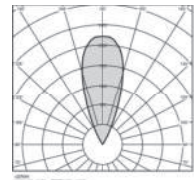

40°

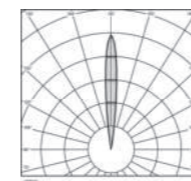

10°

Source type	single power-LED
CCT	2700K 3000K 4000K
CRI	>90
Step MacAdam	2
Lumen output	up to 152 lm
Beam angle	10° 25° 40° 10°x45°
Optical optional	None Honeycomb Louvre
LED Lifetime	L80 B10 50.000h
IP rating	IP66 / 68 10m
IK rating	IK10
Bezel material	Anodized aluminium 20µm anticorodal 6082 Stainless steel 316L
Body material	Anodized aluminium 20µm anticorodal 6082 Stainless steel 316L
Diffuser material	Extra-clear tempered glass
Diffuser thickness	8mm
ISO 9223 class	C5 CX
Operating temperature	-20°C / +50° C
Maximum static load	20kN (2000kg)
Walk-over	Yes
Drive-over	Yes
Power	3W
Input power type	Constant voltage 24V
Power supply	Remote
Insulation class	Class III
Dimmable	Yes
Cable type	H05RN-F 2x0,75 mm <sup>2</sup>
Electrical connection	Parallel
Idroskud® protection	Yes

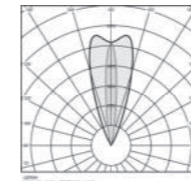

10°x45°

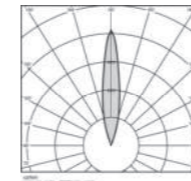

25°

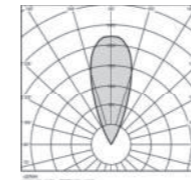

40°

## Oceano 4.0

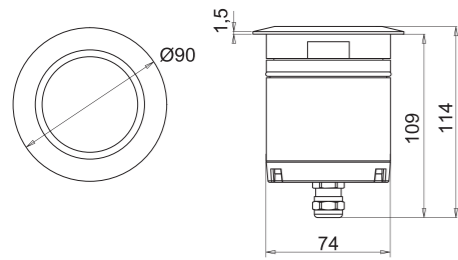

## Oceano 4.1

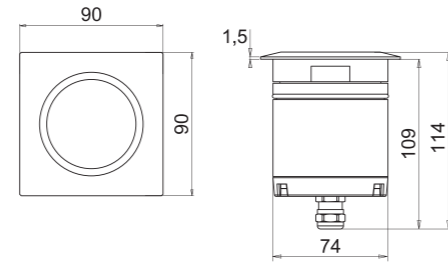

## Oceano 4.0 RGBW

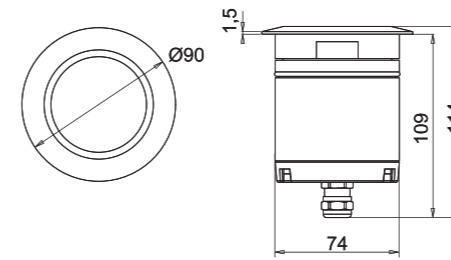

## Oceano 4.1 RGBW

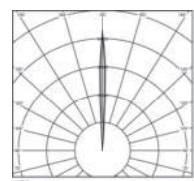
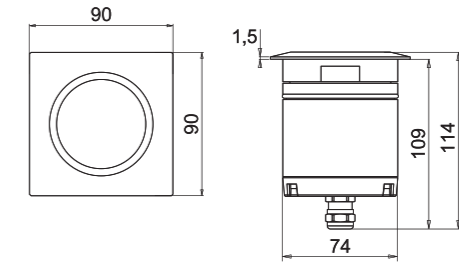

5°

Source type	single power-LED
CCT	2700K 3000K 4000K
CRI	>90
Step MacAdam	2
Lumen output	up to 370 lm
Beam angle	5° 20° 60° 15°x60°
Optical optional	None Honeycomb Louvre
LED Lifetime	L80 B10 50.000h
IP rating	IP66 / 68 10m
IK rating	IK09
Bezel material	Anodized aluminium 20µm anticorodal 6082 Stainless steel 316L Brass
Body material	Anodized aluminium 20µm anticorodal 6082 Stainless steel 316L
Diffuser material	Extra-clear tempered glass
Diffuser thickness	8mm
ISO 9223 class	C5 CX
Operating temperature	-20°C / +50° C
Maximum static load	5kN (500kg)
Walk-over	Yes
Drive-over	No
Power	7W
Input power type	Constant voltage 24V
Power supply	Remote
Insulation class	Class III
Dimmable	Yes
Cable type	H05RN-F 2x0,75 mm²
Electrical connection	Parallel
Idroskud® protection	Yes

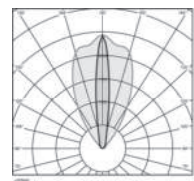

15°x60°

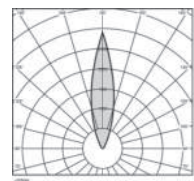

20°

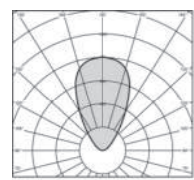

60°

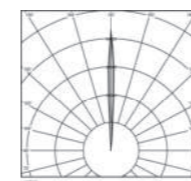

5°

Source type	multi-chip LED
CCT	RGBW (4000K)
CRI	>80
Step MacAdam	3
Lumen output	up to 336 lm
Beam angle	5° 26° 40°
Optical optional	None Honeycomb
LED Lifetime	L80 B10 50.000h
IP rating	IP66 / 68 10m
IK rating	IK09
Bezel material	Anodized aluminium 20µm anticorodal 6082 Stainless steel 316L
Body material	Anodized aluminium 20µm anticorodal 6082 Stainless steel 316L
Diffuser material	Extra-clear tempered glass
Diffuser thickness	8mm
ISO 9223 class	C5 CX
Operating temperature	-20°C / +50° C
Maximum static load	5kN (500kg)
Walk-over	Yes
Drive-over	No
Power	8W
Input power type	Constant voltage 24V
Power supply	Remote
Insulation class	Class III
Dimmable	Yes (PWM)
Cable type	FR5FOEM7-AD8 6x0,5 mm²
Electrical connection	Parallel
Idroskud® protection	Yes

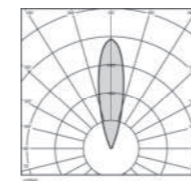

26°

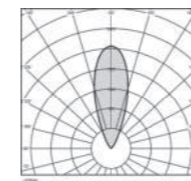

40°

## Oceano 4.2

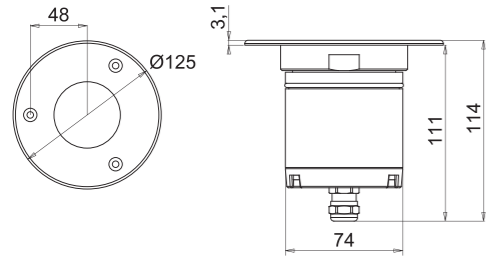

## Oceano 4.3

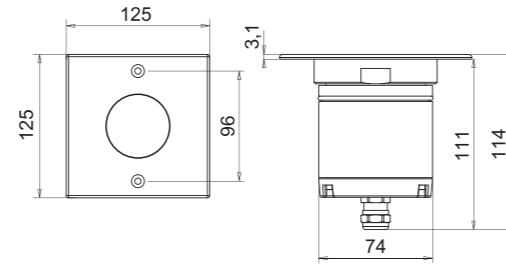

## Oceano 9.1 / 9.2 / 9.3 / 9.4

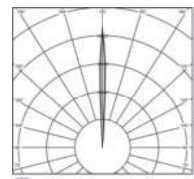
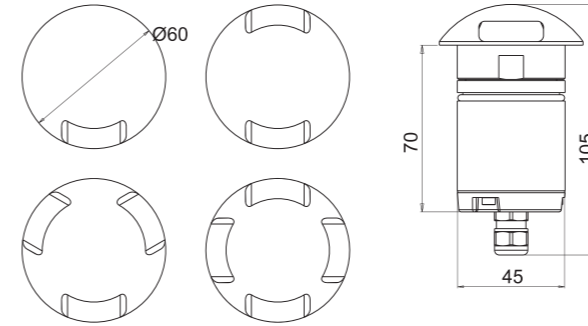

5°

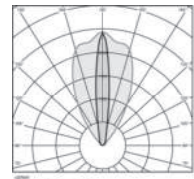

15°x60°

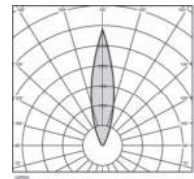

20°

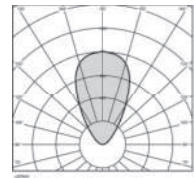

60°

Source type	single power-LED
CCT	2700K 3000K 4000K
CRI	>90
Step MacAdam	2
Lumen output	up to 370 lm
Beam angle	5° 20° 60° 15°x60°
Optical optional	None Honeycomb Louvre
LED Lifetime	L80 B10 50.000h
IP rating	IP66 / 68 10m
IK rating	IK09
Bezel material	Anodized aluminium 20µm anticorodal 6082 Stainless steel 316L
Body material	Anodized aluminium 20µm anticorodal 6082 Stainless steel 316L
Diffuser material	Extra-clear tempered glass
Diffuser thickness	8mm
ISO 9223 class	C5 CX
Operating temperature	-20°C / +50° C
Maximum static load	20kN (2000kg)
Walk-over	Yes
Drive-over	Yes
Power	7W
Input power type	Constant voltage 24V
Power supply	Remote
Insulation class	Class III
Dimmable	Yes
Cable type	H05RN-F 2x0,75 mm <sup>2</sup>
Electrical connection	Parallel
Idroskud® protection	Yes

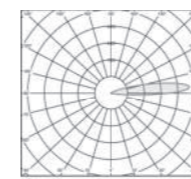

Single grazing

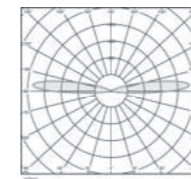

Double grazing

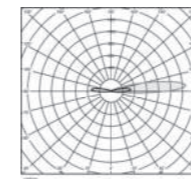

Triple grazing

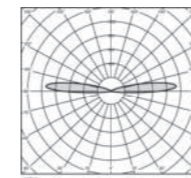

Quadruple grazing

Source type	single power-LED
CCT	2700K 3000K 4000K
CRI	>90
Step MacAdam	2
Lumen output	up to 104 lm
Beam angle	Single grazing Double grazing Triple grazing Quadruple grazing
Optical optional	None
LED Lifetime	L80 B10 50.000h
IP rating	IP66 / 68 10m
IK rating	IK10
Bezel material	Shot peened stainless steel 316L
Body material	Stainless steel 316L
Diffuser material	Silicone ottico
ISO 9223 class	CX
Operating temperature	-20°C / +50° C
Maximum static load	5kN (500kg)
Walk-over	Yes
Drive-over	No
Power	3W
Input power type	Constant voltage 24V
Power supply	Remote
Insulation class	Class III
Dimmable	Yes
Cable type	H05RN-F 2x0,75 mm <sup>2</sup>
Electrical connection	Parallel
Idroskud® protection	Yes

## Special anodizations

The OCEANO series offers unparalleled customization. Available – upon request – in 24 stunning new finishes, including bronze, chrome, and rose gold. All of these colors are achieved through an anodizing treatment and subsequent hand-brushing.



## Accessories

Type	Model	Code	Description
Recessed box	OCEANO 1.0 / 1.1	CEAZZZ000	Draining recessed box
Recessed box	OCEANO 1.0 / 1.1	CEAZZZ001	Slim draining recessed box
Recessed box	OCEANO 1.0 / 1.1	CEAZZZ002	Waterproof slim recessed box
Mounting kit	OCEANO 1.0 / 1.1	CEAZZZ014	Spring for ceiling mounting
Recessed box	OCEANO 2.0 / 2.1	CEAZZZ003	Draining recessed box
Recessed box	OCEANO 2.0 / 2.1	CEAZZZ004	Slim draining recessed box
Recessed box	OCEANO 2.0 / 2.1	CEAZZZ005	Waterproof slim recessed box
Mounting kit	OCEANO 2.0 / 2.1	CEAZZZ015	Spring for ceiling mounting
Recessed box	OCEANO 3.0 / 3.1	CEAZZZ006	Draining recessed box
Recessed box	OCEANO 3.0 / 3.1	CEAZZZ007	Slim draining recessed box
Recessed box	OCEANO 3.0 / 3.1	CEAZZZ008	Waterproof slim recessed box
Mounting kit	OCEANO 3.0 / 3.1	CEAZZZ018	Spring for ceiling mounting
Recessed box	OCEANO 3.2 / 3.3	CEAZZZ009	Drive-over recessed box
Recessed box	OCEANO 4.0 / 4.1	CEAZZZ010	Draining recessed box
Recessed box	OCEANO 4.0 / 4.1	CEAZZZ011	Slim draining recessed box
Recessed box	OCEANO 4.0 / 4.1	CEAZZZ012	Waterproof slim recessed box
Recessed box	OCEANO 4.2 / 4.3	CEAZZZ013	Drive-over recessed box

## Power supplies

Consult the power supply table on the Mizar website in the Download section



Type	Model	Code	Description
Power supply	Every model	MID0019	Power supply DC 24V 14,4W 600mA IP67 ON/OFF
Power supply	Every model	MID0020	Power supply DC 24V 36W 1,5A IP67 ON/OFF
Power supply	Every model	MID0021	Power supply DC 24V 24W 1A IP67 DALI
Control unit	OCEANO 4.0 / 4.1 RGBW	MID0023	Control unit WT5 5 channels RGBW PWM/WiFi
Remote	OCEANO 4.0 / 4.1 RGBW	MID1000	Remote RT5 RGB+CCT 1 zone RF 2.4GHZ
Touch panel	OCEANO 4.0 / 4.1 RGBW	MID1001	Touch panel da parete TW5-4 RGB+CCT 4 zones

## Code configurator

Model	CCT	CRI	Beam angle	Optical optionals	Finishing	Cable length	Version
CEA00 OCEANO 1.0	C 2700K	C CRI > 90	S 15°	0 None	00 Aluminium / Aluminium	A 0,4 m	00 Standard
	D 3000K		E 20°x43°		01 Steel / Steel	C 1,5 m	
	F 4000K		M 25°		03 Steel / Brass	H 5 m	
CEA01 OCEANO 1.1	C 2700K	C CRI > 90	S 15°	0 None	00 Aluminium / Aluminium	A 0,4 m	00 Standard
	D 3000K		M 25°		01 Steel / Steel	C 1,5 m	
	F 4000K		L 40°		03 Steel / Brass	H 5 m	
CEA02 OCEANO 2.0	C 2700K	C CRI > 90	S 10°	0 None	00 Aluminium / Aluminium	A 0,4 m	00 Standard
	D 3000K		E 10°x53°	1 Honeycomb	01 Steel / Steel	C 1,5 m	
	F 4000K		M 36°		03 Steel / Brass	H 5 m	
CEA03 OCEANO 2.1	C 2700K	C CRI > 90	S 10°	0 None	00 Aluminium / Aluminium	A 0,4 m	00 Standard
	D 3000K		M 36°	1 Honeycomb	01 Steel / Steel	C 1,5 m	
	F 4000K		L 60°		03 Steel / Brass	H 5 m	
CEA04 OCEANO 3.0	C 2700K	C CRI > 90	S 10°	0 None	00 Aluminium / Aluminium	A 0,4 m	00 Standard
	D 3000K		E 10°x45°	1 Honeycomb	01 Steel / Steel	C 1,5 m	
	F 4000K		M 25°	2 Louvre	03 Steel / Brass	H 5 m	
CEA05 OCEANO 3.1	C 2700K	C CRI > 90	S 10°	0 None	00 Aluminium / Aluminium	A 0,4 m	00 Standard
	D 3000K		E 10°x45°	1 Honeycomb	01 Steel / Steel	C 1,5 m	
	F 4000K		M 25°	2 Louvre	03 Steel / Brass	H 5 m	
CEA06 OCEANO 3.2	C 2700K	C CRI > 90	S 10°	0 None	00 Aluminium / Aluminium	A 0,4 m	00 Standard
	D 3000K		E 10°x45°	1 Honeycomb	01 Steel / Steel	C 1,5 m	
	F 4000K		M 25°	2 Louvre		H 5 m	
CEA07 OCEANO 3.3	C 2700K	C CRI > 90	S 10°	0 None	00 Aluminium / Aluminium	A 0,4 m	00 Standard
	D 3000K		E 10°x45°	1 Honeycomb	01 Steel / Steel	C 1,5 m	
	F 4000K		M 25°	2 Louvre		H 5 m	
CEA08 OCEANO 4.0	C 2700K	C CRI > 90	S 5°	0 None	00 Aluminium / Aluminium	A 0,4 m	00 Standard
	D 3000K		E 15°x60°	1 Honeycomb	01 Steel / Steel	C 1,5 m	
	F 4000K		M 20°	2 Louvre	03 Steel / Brass	H 5 m	
CEA09 OCEANO 4.1	C 2700K	C CRI > 90	S 5°	0 None	00 Aluminium / Aluminium	A 0,4 m	00 Standard
	D 3000K		M 26°	1 Honeycomb	01 Steel / Steel	C 1,5 m	
	F 4000K		L 40°	2 Louvre		H 5 m	
CEA08 OCEANO 4.0 RGBW	P RGBW	C CRI > 80	S 5°	0 None	00 Aluminium / Aluminium	A 0,4 m	00 Standard
	D 3000K		M 26°	1 Honeycomb	01 Steel / Steel	C 1,5 m	
	F 4000K		L 40°	2 Louvre		H 5 m	
CEA10 OCEANO 4.2	C 2700K	C CRI > 90	S 5°	0 None	00 Aluminium / Aluminium	A 0,4 m	00 Standard
	D 3000K		E 15°x60°	1 Honeycomb	01 Steel / Steel	C 1,5 m	
	F 4000K		M 20°	2 Louvre		H 5 m	
CEA11 OCEANO 4.3	C 2700K	C CRI > 90	S 5°	0 None	00 Aluminium / Aluminium	A 0,4 m	00 Standard
	D 3000K		E 15°x60°	1 Honeycomb	01 Steel / Steel	C 1,5 m	
	F 4000K		M 20°	2 Louvre		H 5 m	
CEA16 OCEANO 9.1	C 2700K	C CRI > 90	R Grazing	0 None	01 Steel / Steel	A 0,4 m	00 Standard
	D 3000K					C 1,5 m	
	F 4000K					H 5 m	
CEA17 OCEANO 9.2	C 2700K	C CRI > 90	R Grazing	0 None	01 Steel / Steel	A 0,4 m	00 Standard
	D 3000K					C 1,5 m	
	F 4000K					H 5 m	
CEA18 OCEANO 9.3	C 2700K	C CRI > 90	R Grazing	0 None	01 Steel / Steel	A 0,4 m	00 Standard
	D 3000K					C 1,5 m	
	F 4000K					H 5 m	
CEA19 OCEANO 9.4	C 2700K	C CRI > 90	R Grazing	0 None	01 Steel / Steel	A 0,4 m	00 Standard
	D 3000K					C 1,5 m	
	F 4000K					H 5 m	

### Configuration example

CEA00	C	C	S	0	00	A	00
-------	---	---	---	---	----	---	----

CEA00CCS000A00 - OCEANO 1.0 1W AL-AL 15° 2700K 24V 0,4M





MIZAR  
a brand of ReeR spa

Via Carcano, 32  
10153 Turin - Italy

mizar.it  
info@mizar.it