



mizar

VITRUM

# Vitrum

[ˈvi:trum]

VITRUM is simplicity with style: a sophisticated, elegant, and durable flush-mounted fixture, designed to blend into the environment and leave space for light to be the sole protagonist. Thanks to its minimalist design, the quality of its construction materials, and the various optical solutions available, it is the ideal choice for projects that require discretion and refinement, enhancing every context with harmony.



CX  
ISO9223

IK10

IP66

IP68



# Vitrum

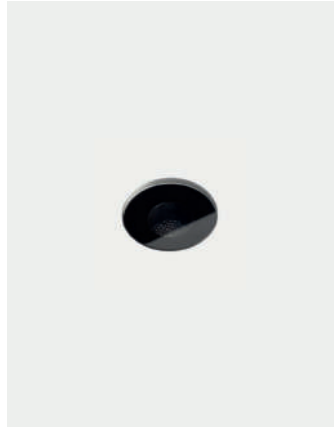

Vitrum 1.0

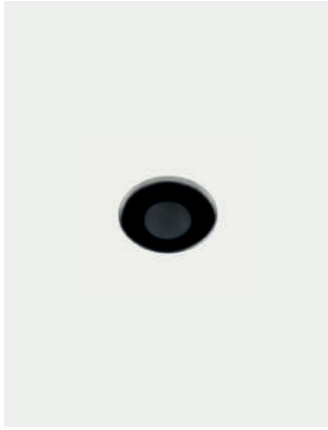

Vitrum 1.1

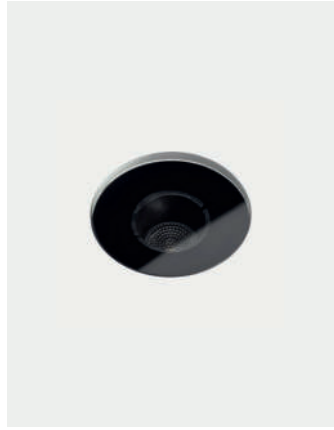

Vitrum 2.0

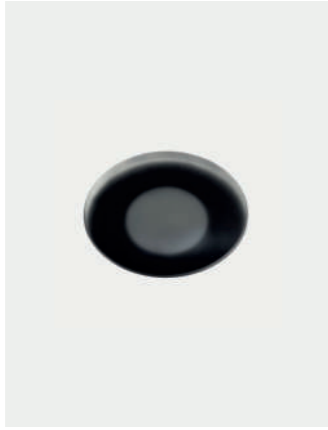

Vitrum 2.1



Vitrum 3.0

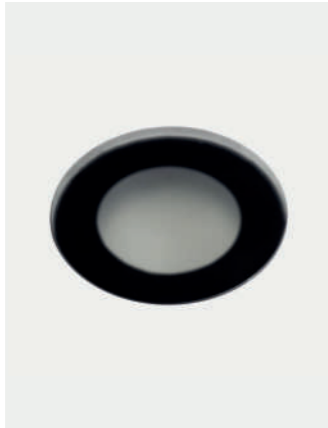

Vitrum 3.1

# mizar

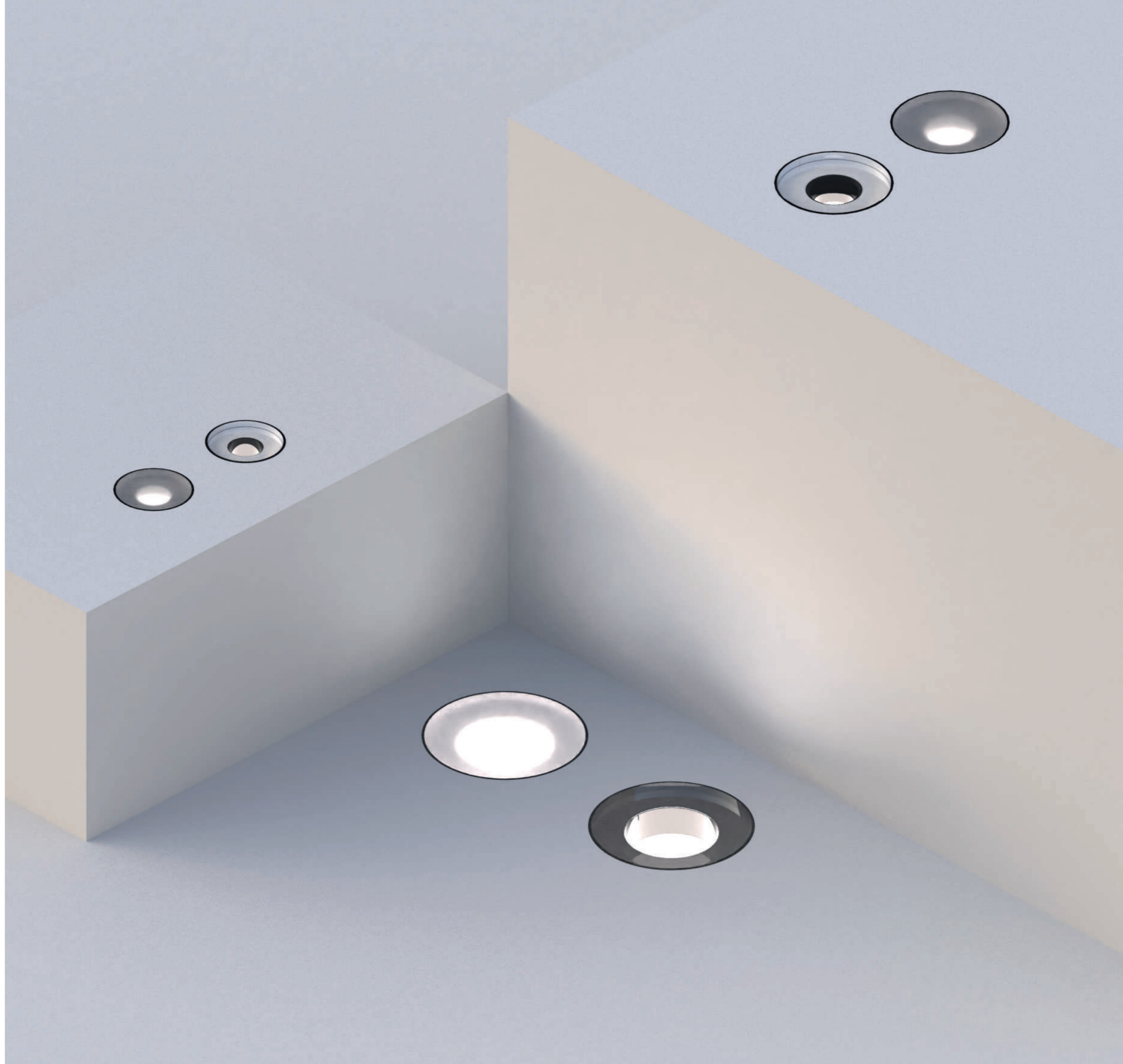

# Vitrum / Product features



## Construction quality as the first goal

At Mizar we think that one of the first features of a "Made in Italy" product is an excellent build quality. VITRUMs are turned from solid, made of 20µm black anodized 6082 anticorrosion aluminum and equipped with 8-10mm thick extra-clear tempered glass.

## Corrosion resistance at the highest level

The care taken in the design and choice of materials makes it possible to achieve the highest classes of the international ISO 9223 standard. All VITRUMs are rated CX ("Extreme").



## A surprising robustness

The VITRUM range features a tempered glass diffuser 8 to 10 mm thick (depending on size). This peculiarity, not only characterizes it aesthetically, but also makes it certified as walk-over, up to 500kg of static load.



## Highest degrees of protection

VITRUMs are fully protected against entry of any kind of dust (IP 6X) and protected against permanent immersion to a depth of 3 meters (IP X8). The products are also tested against high-pressure water jets (IP X6). 100 liters per minute, with a pressure of 100 kPa, at a distance of 3 m.

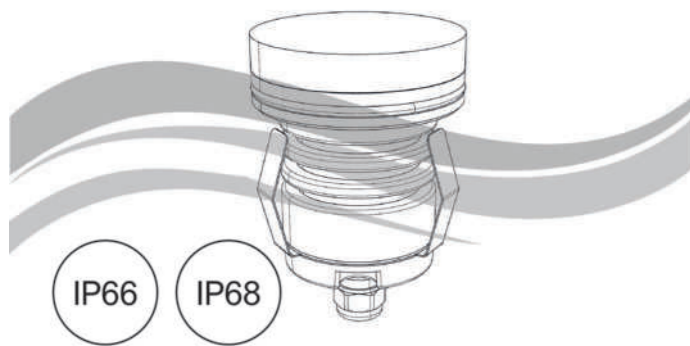

## IdroSkud®

Innovative Mizar exclusive patent to protect electronic components from voltage spikes, polarity reversal, moisture or water infiltrations through the power cable.

## Versions with "direct-view" opal diffuser

VITRUM has the option of being equipped with an opal glass to create diffused light and have maximum visual comfort. The VITRUM 1.1, VITRUM 2.1 and VITRUM 3.1 models have this feature.



## Wide range of optics

All VITRUMs can be equipped with narrow, medium, wide or elliptical optics. Offering maximum design flexibility at the lighting level.

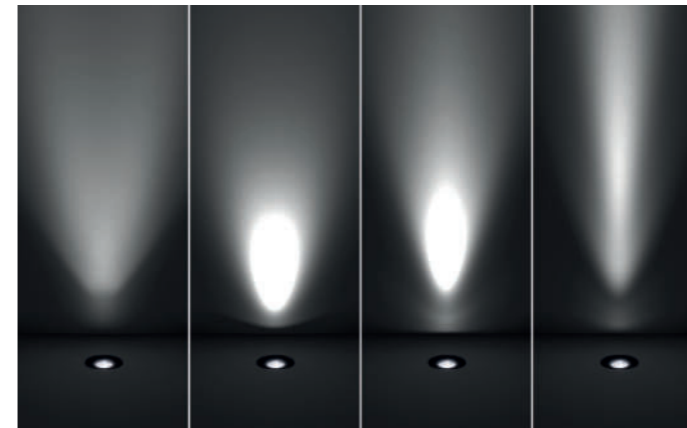

## Wide choice of color temperatures

The series is offered with a wide choice of color temperatures: 2700K, 3000K and 4000K. In addition – upon request – versions with extremely warm color temperature (2200K) are available.

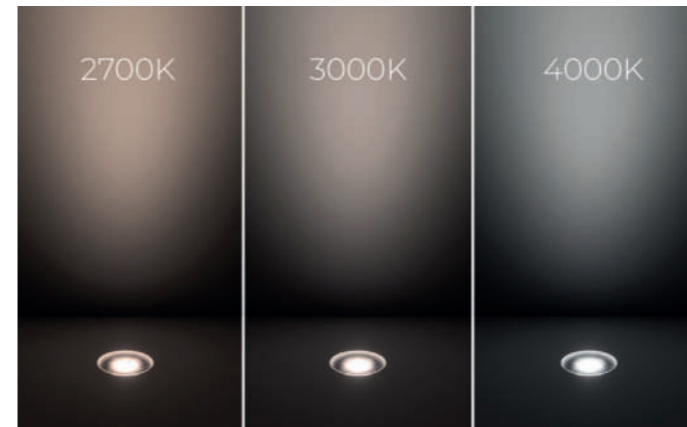



# Vitrum 1.0 / 1.1

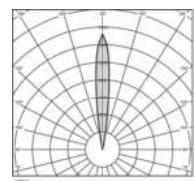
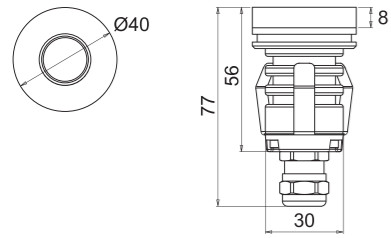

10°

Source type	single power-LED
CCT	2700K 3000K 4000K
CRI	>90
Step MacAdam	2
Lumen output	up to 99 lm
Beam angle	10° 36° 60° 10°x53° Diffused
Optical optional	None Honeycomb Louvre
LED Lifetime	L80 B10 50.000h
IP rating	IP66 / 68
IK rating	IK10
Finishing colour	Black screen-printing White screen-printing
Body material	Anodized aluminium 20µm anticorodal 6082
Diffuser material	Extra-clear tempered glass
Diffuser thickness	8mm
ISO 9223 class	CX
Operating temperature	-20°C / +50° C
Maximum static load	5kN (500kg)
Walk-over	Yes
Drive-over	No
Power	2W
Input power type	Constant voltage 24V
Power supply	Remote
Insulation class	Class III
Dimmable	Yes
Cable type	H05RN-F 2x0,75 mm <sup>2</sup>
Electrical connection	Parallel
Idroskud® protection	Yes

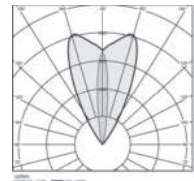

10°x53°

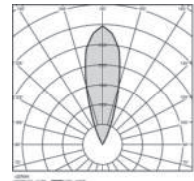

36°

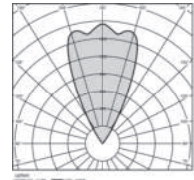

60°

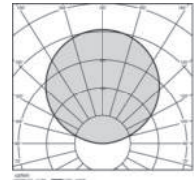

Diffused

# Vitrum 2.0 / 2.1

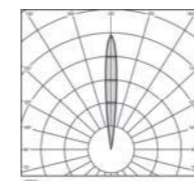
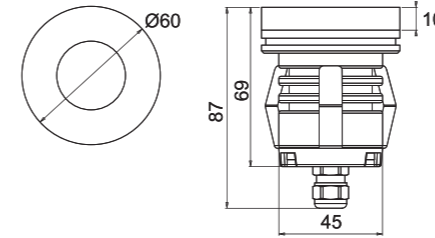

10°

Source type	single power-LED
CCT	2700K 3000K 4000K
CRI	>90
Step MacAdam	2
Lumen output	up to 152 lm
Beam angle	10° 25° 40° 10°x45° Diffused
Optical optional	None Honeycomb Louvre
LED Lifetime	L80 B10 50.000h
IP rating	IP66 / 68
IK rating	IK10
Finishing colour	Black screen-printing White screen-printing
Body material	Anodized aluminium 20µm anticorodal 6082
Diffuser material	Extra-clear tempered glass
Diffuser thickness	10mm
ISO 9223 class	CX
Operating temperature	-20°C / +50° C
Maximum static load	5kN (500kg)
Walk-over	Yes
Drive-over	No
Power	3W
Input power type	Constant voltage 24V
Power supply	Remote
Insulation class	Class III
Dimmable	Yes
Cable type	H05RN-F 2x0,75 mm <sup>2</sup>
Electrical connection	Parallel
Idroskud® protection	Yes

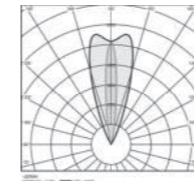

10°x45°

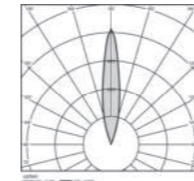

25°

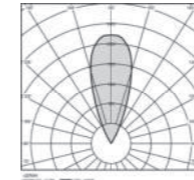

40°

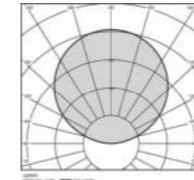

Diffused

# Vitrum 3.0 / 3.1

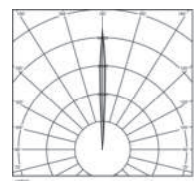
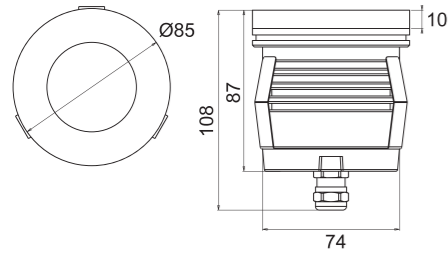

5°

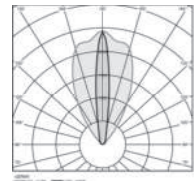

15x60°

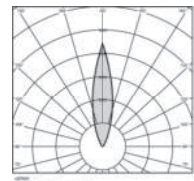

20°

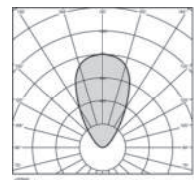

60°

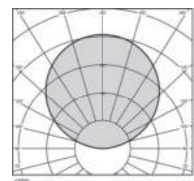

Diffused

Source type	single power-LED
CCT	2700K 3000K 4000K
CRI	>90
Step MacAdam	2
Lumen output	up to 370 lm
Beam angle	5° 20° 60° 15°x60° Diffused
Optical optional	None Honeycomb Louvre
LED Lifetime	L80 B10 50.000h
IP rating	IP66 / 68
IK rating	IK10
Finishing colour	Black screen-printing White screen-printing
Body material	Anodized aluminium 20µm anticorodal 6082
Diffuser material	Extra-clear tempered glass
Diffuser thickness	10mm
ISO 9223 class	CX
Operating temperature	-20°C / +50° C
Maximum static load	5kN (500kg)
Walk-over	Yes
Drive-over	No
Power	7W
Input power type	Constant voltage 24V
Power supply	Remote
Insulation class	Class III
Dimmable	Yes
Cable type	H05RN-F 2x0,75 mm <sup>2</sup>
Electrical connection	Parallel
Idroskud® protection	Yes



## Accessories

Type	Model	Code	Description
Recessed box	VITRUM 1.0 / 1.1	VITZZZ000	Draining recessed box
Recessed box	VITRUM 1.0 / 1.1	VITZZZ003	Slim draining recessed box
Mounting kit	VITRUM 1.0 / 1.1	VITZZZ006	Plasterboard ring
Mounting kit	VITRUM 1.0 / 1.1	VITZZZ009	Suction cup
Recessed box	VITRUM 2.0 / 2.1	VITZZZ001	Draining recessed box
Recessed box	VITRUM 2.0 / 2.1	VITZZZ004	Slim draining recessed box
Mounting kit	VITRUM 2.0 / 2.1	VITZZZ007	Plasterboard ring
Mounting kit	VITRUM 2.0 / 2.1	VITZZZ010	Suction cup
Recessed box	VITRUM 3.0 / 3.1	VITZZZ002	Draining recessed box
Recessed box	VITRUM 3.0 / 3.1	VITZZZ005	Slim draining recessed box
Mounting kit	VITRUM 3.0 / 3.1	VITZZZ008	Plasterboard ring
Mounting kit	VITRUM 3.0 / 3.1	VITZZZ011	Suction cup

## Code configurator

Model	CCT	CRI	Beam angle	Optical options	Finishing	Cable length	Version
VIT01 VITRUM 1.0	C 2700K	C CRI > 90	S 10°	0 None	00 Transparent black 02 Transparent white	A 0,4 m	00 Standard
	D 3000K		E 10°x53°	1 Honeycomb		C 1,5 m	
	F 4000K		M 36°			H 5 m	
			L 60°			M 10 m	
						P 15 m	
VIT01 VITRUM 1.1	C 2700K	C CRI > 90	D Diffused	0 None	01 Opal black 03 Opal white	A 0,4 m	00 Standard
	D 3000K					C 1,5 m	
	F 4000K					H 5 m	
						M 10 m	
						P 15 m	
VIT02 VITRUM 2.0	C 2700K	C CRI > 90	S 10°	0 None	00 Transparent black 02 Transparent white	A 0,4 m	00 Standard
	D 3000K		E 10°x45°	1 Honeycomb		C 1,5 m	
	F 4000K		M 25°			H 5 m	
			L 40°			M 10 m	
						P 15 m	
VIT02 VITRUM 2.1	C 2700K	C CRI > 90	D Diffused	0 None	01 Opal black 03 Opal white	A 0,4 m	00 Standard
	D 3000K					C 1,5 m	
	F 4000K					H 5 m	
						M 10 m	
						P 15 m	
VIT03 VITRUM 3.0	C 2700K	C CRI > 90	S 5°	0 None	00 Transparent black 02 Transparent white	A 0,4 m	00 Standard
	D 3000K		E 15°x60°	1 Honeycomb		C 1,5 m	
	F 4000K		M 20°			H 5 m	
			L 60°			M 10 m	
						P 15 m	
VIT03 VITRUM 3.1	C 2700K	C CRI > 90	D Diffused	0 None	01 Opal black 03 Opal white	A 0,4 m	00 Standard
	D 3000K					C 1,5 m	
	F 4000K					H 5 m	
						M 10 m	
						P 15 m	

### Configuration example

VIT01	C	C	S	0	00	A	00
-------	---	---	---	---	----	---	----

VIT01CCS000A00 - VITRUM 1.0 2W Black 10° 2700K 24V 0,4m

## Power supplies

Consult the power supply table on the Mizar website in the Download section



Type	Model	Code	Description
Power supply	VITRUM 1.0 / 1.1 / 2.0 / 2.1 / 3.0 / 3.1	MID0019	Power supply DC 24V 14,4W 600mA IP67 ON/OFF
Power supply	VITRUM 1.0 / 1.1 / 2.0 / 2.1 / 3.0 / 3.1	MID0020	Power supply DC 24V 36W 1,5A IP67 ON/OFF
Power supply	VITRUM 1.0 / 1.1 / 2.0 / 2.1 / 3.0 / 3.1	MID0021	Power supply DC 24V 24W 1A IP67 DALI





MIZAR  
a brand of ReeR spa

Via Carcano, 32  
10153 Turin - Italy

mizar.it  
info@mizar.it